



# 天驰门禁控制系统

## TYCHI ACCESS CONTROLS

SIMPLE  
简单

雅致  
ELEGANT

安全  
SECURE

天驰电子有限公司  
Tychi Systems, Inc.



## 企业简介 company profile



天驰是一家私营企业，于2002年成立在美国的新罕布什尔州，其总部设在美国新罕布什尔州塞勒姆的一个现代化工业园内。在中国设立的分公司“天驰电子有限公司”位于被称为中国南方生产基地与国内生产总值最高的省份——广东省佛山市顺德区杏坛镇。天驰电子有限公司拥有一批技术力量雄厚的锁具设计和开发人才，并引进美国先进的生产设备与生产技术。

天驰的使命是将世界级的门禁控制技术带给消费者。天驰电子是第一个为家庭和企业从制图板到设计生产生物统计学产品的公司。这些产品不仅仅适合军事和政府部门，同时也适合复杂的公司系统。在具有最先进的生物统计学技术做后盾的基础上，天驰电子认真分析了家庭和企业等大多数消费者的需求，以便更好地运用这项技术。这门技术发源于美国波士顿并直接授权于中国的最高质量生产商——天驰电子，从而架起了世界沟通的桥梁。



Tychi Systems, Inc. was founded in 2002, incorporated in the State of New Hampshire and is privately held. Its headquarters are located in a modern industrial park in Salem, New Hampshire, U.S.A.

Tychi Systems' mission is to bring world-class access control technology to the consumer. We are the first company to design biometric products specifically for the home and small business owner starting from a clean drawing board. The products are not adapted from military or government experiments, or from complex corporate systems. Starting with knowledge of the most advanced biometric technology, Tychi Systems analyzed needs of the cost-conscious consumer within the home and business environment and applied the technology in a refreshingly simple and functional manner. Having both the technology and manufacturing resources in China, Tychi Systems benefits from an optimal combination of global teamwork.

# TYCHI SYSTEMS



## 目录 contents



指纹保险系列  
Fingerprint Safe  
P.01



无簧安全指纹锁系列  
Fingerprint Deadbolt Locks  
P.07



指纹门禁系统  
Fingerprint Entry Systems  
P.03



杆式无簧安全指纹锁系列  
Fingerprint Deadbolt Lever Version  
P.08



球形指纹锁系列  
Fingerprint Knob Locks  
P.04



无簧安全锁与单向弹簧 浴室锁系列  
Keyed Locks  
P.09



杆式指纹锁系列  
Fingerprint Lever Locks  
P.05

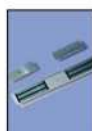

电磁力门锁系列与附件类  
Electromagnetic Locks and Accessories  
P.11



弧形杆式指纹锁系列  
Fingerprint Curve-In Handle Locks  
P.06



功能与表面处理一览表  
Functions and Finish Breakdown  
P.12

## 指纹保险柜系列 Fingerprint Safe



型号: BKK-G131612  
 外箱尺寸: 330 (高) × 420 (宽) × 320 (深) mm  
 重量: 45 kg  
 外箱厚度: 6 × 6 × 10mm  
 Model No.: BKK-G131612  
 Outside Dim: 13"H × 16.53"W × 12.6"D  
 Weight: 99 lbs.  
 Frame Thickness: 0.23" × 0.23" × 0.39"



型号: BKK-G171712  
 外箱尺寸: 450 (高) × 380 (宽) × 320 (深) mm  
 重量: 56 kg  
 外箱厚度: 6 × 6 × 10mm  
 Model No.: BKK-G171712  
 Outside Dim: 17.7"H × 15"W × 12.6"D  
 Weight: 123 lbs.  
 Frame Thickness: 0.23" × 0.23" × 0.39"



型号: BKK-G191514  
 外箱尺寸: 530 (高) × 390 (宽) × 340 (深) mm  
 重量: 65 kg  
 外箱厚度: 6 × 6 × 10mm  
 Model No.: BKK-G191514  
 Outside Dim: 20.9"H × 15.35"W × 13.39"D  
 Weight: 143 lbs.  
 Frame Thickness: 0.23" × 0.23" × 0.39"



型号: BKK-G301715  
 外箱尺寸: 765 (高) × 450 (宽) × 400 (深) mm  
 重量: 97 kg  
 外箱厚度: 6 × 6 × 10mm  
 Model No.: BKK-G301715  
 Outside Dim: 30.1"H × 17.7"W × 15.75"D  
 Weight: 214 lbs.  
 Frame Thickness: 0.23" × 0.23" × 0.39"



指纹保险柜系列  
Fingerprint Safe



型号: BKK-H131612  
外箱尺寸: 330 (高) × 420 (宽) × 320 (深) mm  
重量: 45 kg  
外箱厚度: 6 × 6 × 10 mm  
Model No.: BKK-131612  
Outside Dim: 13"H × 16.53"W × 12.6"D  
Weight: 99 lbs  
Frame Thickness: 0.23" × 0.23" × 0.39"



型号: BKK-H171712  
外箱尺寸: 450 (高) × 380 (宽) × 320 (深) mm  
重量: 56 kg  
外箱厚度: 6 × 6 × 10 mm  
Model No.: BKK-H171712  
Outside Dim: 17.7"H × 15"W × 12.6"D  
Weight: 123 lbs.  
Frame Thickness: 0.23" × 0.23" × 0.39"



型号: BKK-H191514  
外箱尺寸: 530 (高) × 390 (宽) × 340 (深) mm  
重量: 65 kg  
外箱厚度: 6 × 6 × 10 mm  
Model No.: BKK-H191514  
Outside Dim: 20.9"H × 15.35"W × 13.39"D  
Weight: 143 lbs.  
Frame Thickness: 0.23" × 0.23" × 0.39"



型号: BKK-H301715  
外箱尺寸: 765 (高) × 450 (宽) × 400 (深) mm  
重量: 97 kg  
外箱厚度: 6 × 6 × 10 mm  
Model No.: BKK-H301715  
Outside Dim: 30.1"H × 17.7"W × 15.75"D  
Weight: 214 lbs.  
Frame Thickness: 0.23" × 0.23" × 0.39"



这款时尚美观的指纹保险柜强化防盗、防撬安全性功能，能高效保护您的重要文件、现金、珠宝首饰各其它贵重物品等。可广泛应用于家庭和办公室等各个领域。  
This beautifully crafted fingerprint safe protects your important documents, cash, jewelry and other valuables conveniently at homes and offices.

## 指纹门禁系统 Fingerprint Entry Systems

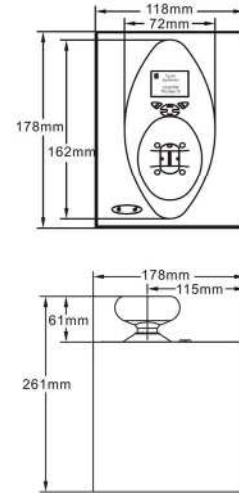

BioFlex是一种固定在门锁中央的指纹感应识别生物门禁系统门锁。双门电磁锁由BioFlex控制，可承受高达1000英镑的拉力。BioFlex整个操作系统设置在电子系统里，由按键进行操作，并显示在LCD显示器上。在门顶部安装一个120度的人体微波震感器可直接探测进入。系统电源由220V交流电供电并具备后备电池，以防停电。

The BioFlex Series is a biometric door lock system with a fingerprint sensor located at the center of the door knob. An LCD display and key pad provide access to the programming functions. A 120 degrees microwave motion sensor mounted on-top of the door to detect direct access to the door from inside. An electromagnetic lock controlled by BioFlex provides up-to 1000 Lbs locking forces. All components of the system are encased and hidden inside the building structure. The system is powered by 220V AC and with backup power in-case of power outage.

型号: BioFlex 200  
订单号码: BF2004-SN/PB  
颜色: 银色(钢拉丝)/金色(铜亮光)  
材质: 锌合金

Model: BioFlex 200  
Order No.: BF2004-SN/PB  
Color: Satin Nickel and Polish Brass  
Material: Zinc Alloy

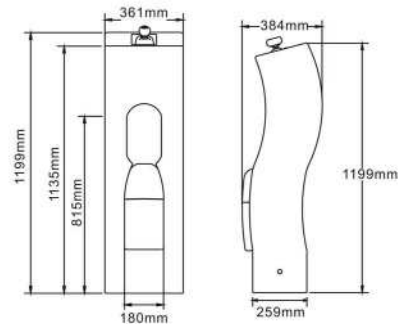

型号: BioFlex 100  
订单号码: BF1004-SN/PB  
颜色: 银色(钢拉丝)/金色(铜亮光)  
材质: 锌合金

Model: BioFlex 100  
Order No.: BF1004-SN/PB  
Color: Satin Nickel and Polish Brass  
Material: Zinc Alloy

球形指纹锁系列  
Fingerprint Knob Locks

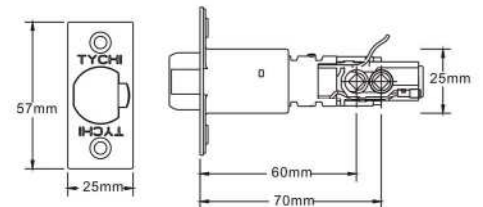
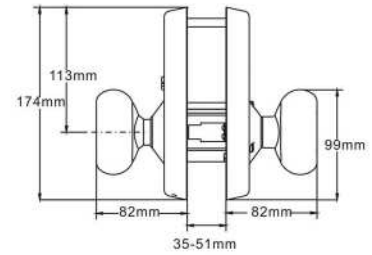
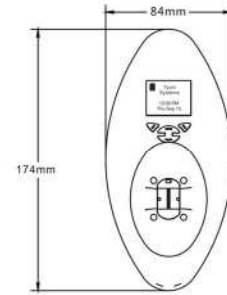

型号: BioKnob 100S  
订单号码: BF1001-SN/PB  
颜色: 银色(钢拉丝)/金色(铜亮光)  
材质: 锌合金

Model: BioKnob 100S  
Order No.: BF1001-SN/PB  
Color: Satin Nickel and Polish Brass  
Material: Zinc Alloy

BioKnob 是一种固定在门锁中央的指纹感应生物系统门锁。整个操作系统设置在电子系统里, 由按键进行操作, 并显示在LCD显示器上。

The BioKnob is a biometric door lock system with a thermal fingerprint sensor located at the center of the door knob. An LCD display and key pad provide access to the programming functions. All components of the system are encased within the lock.

# TYCHI SYSTEMS

## 杆式指纹锁系列 Fingerprint Lever Locks

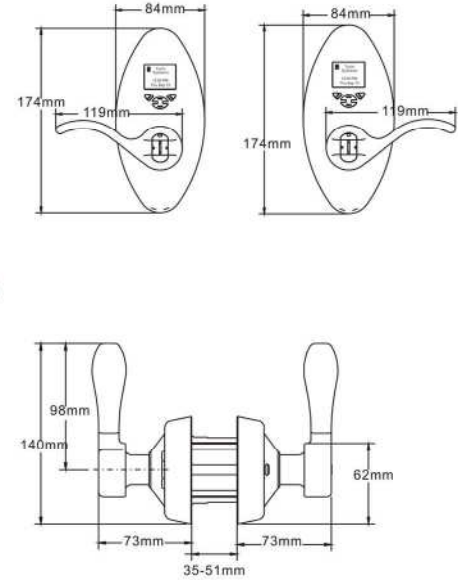

Biolever 是一种固定在门锁中央的指纹感应器的生物识别门锁系统。功能由 LCD 显示器和按键提供。整个操作系统设置在门锁里。BioLever 已被美国残疾人法案一致认可安装可供残疾人之用。

The BioLever is a biometric door lock system with a fingerprint sensor located at the center of the beautifully curved handle. An LCD display and key pad provide access to the programming functions. All components of the system are encased within the lock. BioLever is an ADA (Americans with Disabilities Act) compliance.

型号: BioLever 100R/L  
订单号码: BF1002-PN/AB(左手手柄或右手手柄)  
颜色: 珍珠铬/青古铜  
材质: 锌合金

Model: BioLever 100R/L  
Order No.: BF1002-PN/AB(Left or Right Handed)  
Color: Polish Nickel and Satin Antique Brass  
Material: Zinc Alloy

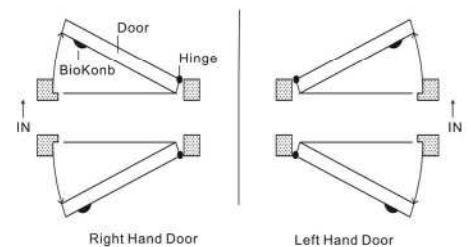
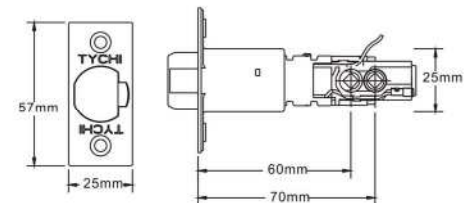



弧形杆式指纹锁系列  
Fingerprint Curve-In Handle Locks

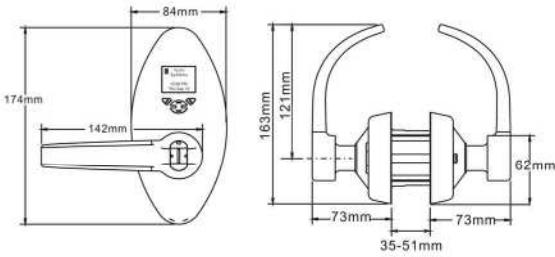

型号: BioFire 100 R/L  
订单号码: BF1003-PN/AB(左手手柄或右手手柄)  
颜色: 珍珠铬/青古铜  
材质: 锌合金

Model: BioFire 100 R/L  
Order No.: BF1003-PN/AB(Left or Right Handed)  
Color: Polish Nickel and Satin Antique Brass  
Material: Zinc Alloy

The BioFire 是天驰电子的第三个设计产品, 弧形的防火把手, 并运用了 BioKnob 和 BioLever 同样的功能。

The BioFire™ is a third product from the design team of Tychi Systems, with curved-in handle for fire safety and ADA compliance and maintaining the same functionality as the BioKnob and BioLever.

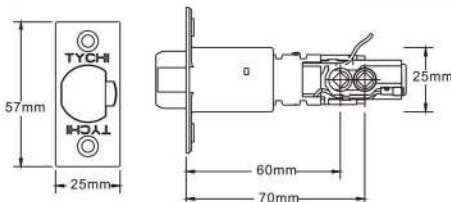
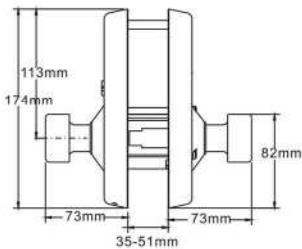

## 无簧安全指纹锁系列 Fingerprint Deadbolt Locks

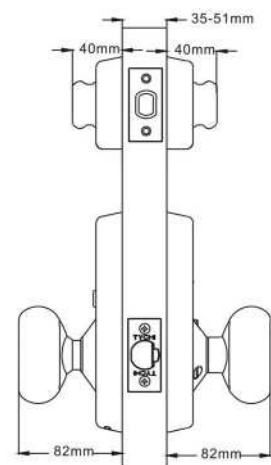
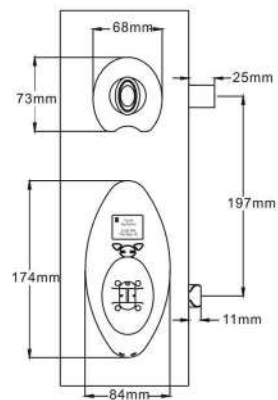

高度安全防护设计，此款精美的指纹门锁最适合家庭和办公室使用。BioDeadbolt™ 是一款无簧安全锁胆的生物识别系统门锁。指纹感应器位于门锁手柄的中央。

Designed with the highest security, this beautifully crafted fingerprint deadbolt door lock is perfect for your homes and offices. The BioDeadbolt™ is a biometric dead bolt door lock system with a single point locking and a pass-through latch. A fingerprint sensor located at the center of the door knob or lever for fingerprint access.

型号: BioDeadbolt 100S  
订单号码: BD1005-SN/PB  
颜色: 银色 (钢拉丝)/金色 (铜亮光)  
材质: 锌合金

Model: BioDeadbolt 100S  
Order No.: BD1005-SN/PB  
Color: Satin Nickel and Polish Brass  
Material: Zinc Alloy

杆式无簧安全指纹锁系列  
Fingerprint Deadbolt Lever Version

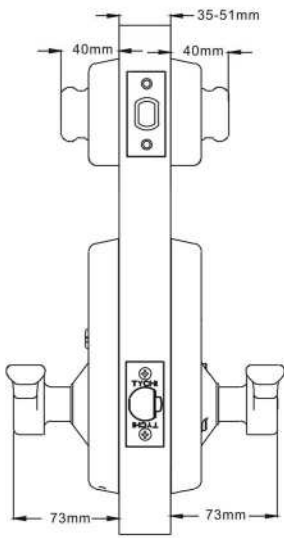
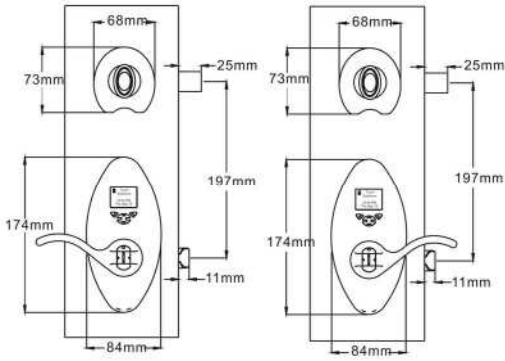

型号: BioDeadbolt 200R/L  
 订单号码: BD2005-PN/AB(左手手柄或右手手柄)  
 颜色: 珍珠铬/青古铜  
 材质: 锌合金

Model: BioDeadbolt 200R/L  
 Order No.: BD2005-PN/AB(Left or Right Handel)  
 Color: Polish Nickel and Satin Antique Brass  
 Material: Zinc Alloy

# TYCHI SYSTEMS

## 无簧安全锁与单向弹簧锁系列 Deadbolt and Dead Latch Locks

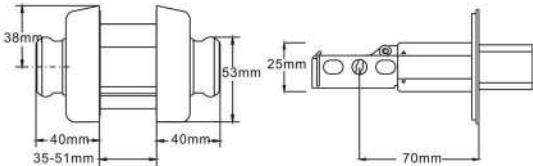

型号: Flex 100M  
 订单号: F1007-PB/AB/PN/SN  
 颜色: 铜亮光 (金色) / 青古铜/珍珠铬/钢拉丝 (银色)  
 材料: 锌合金

Model No.: Flex 100M  
 Order No.: F1007-PB/AB/PN/SN  
 Color: Polish Brass, Antique Brass, Polish Nickel,  
 Satin Nickel  
 Material: Zinc Alloy

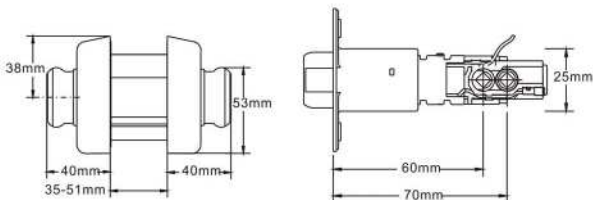

型号: Flex 200M  
 订单号: F2007-PB/AB/PN/SN  
 颜色: 铜亮光 (金色) / 青古铜/珍珠铬/钢拉丝 (银色)  
 材料: 锌合金

Model No.: Flex 200M  
 Order No.: F2007-PB/AB/PN/SN  
 Color: Polish Brass, Antique Brass, Polish Nickel,  
 Satin Nickel  
 Material: Zinc Alloy

Flex™ 系列产品适用于任何办公室和家庭门锁。其光滑的外观以及优雅的设计使其在无需球形把手和杆式把手的互换技术中应用自如。

Flex™ series fits any door in your office or your home. Within its smooth exterior and elegant design, the interchangeable technology eliminates the need for knobs and levers.

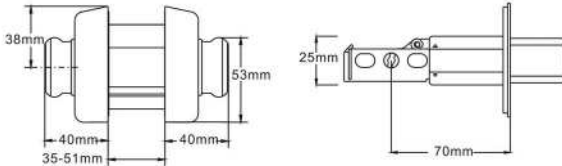

型号: Flex 300M  
 订单号: F3007-PB/AB/PN/SN  
 颜色: 铜亮光 (金色)/青古铜/珍珠铬/钢拉丝 (银色)  
 材料: 锌合金

Model No.: Flex 300M  
 Order No.: F3007-PB/AB/PN/SN  
 Color: Polish Brass, Antique Brass, Polish Nickel,  
 Satin Nickel  
 Material: Zinc Alloy



型号: Flex 400M  
 订单号: F4007-PB/AB/PN/SN  
 颜色: 铜亮光 (金色)/青古铜/珍珠铬/钢拉丝 (银色)  
 材料: 锌合金

Model No.: Flex 400M  
 Order No.: F4007-PB/AB/PN/SN  
 Color: Polish Brass, Antique Brass, Polish Nickel,  
 Satin Nickel  
 Material: Zinc Alloy

Flex™ 500-800M系列与100-400M系列尺寸大小相同。500-800M指销器稍大，操作更稳定，适用于办公室或家庭。

Flex™ 500-800M series have the same footprint as the 100-400M. 500-800M has a larger thumb turn for a firmer grip during operation. It fits on doors in your office or your home.

## 电磁力门锁系列

### Electromagnetic Locks

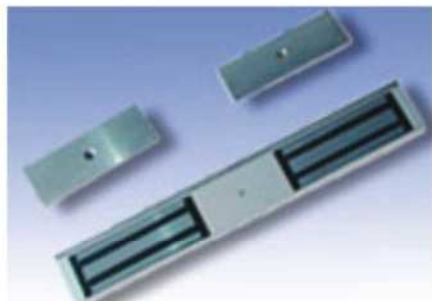

类型：双联挂式磁力锁  
 尺寸：500×47×24mm  
 拉力：180kg、280kg、380kg  
 电压：DC12V 或 DC24V  
 工作电流：450mA、225mA  
 安全类型：通电上锁、断电开锁

Type: Twin hanging type  
 Dimension: 500×47×24mm  
 Pull: 180kg、280kg、380kg  
 Power supply: DC12V or DC24V  
 Electrical current: 450mA、225mA  
 Safety mode: Power-on to lock, Power-off to open



类型：单联挂式磁力锁  
 尺寸：208×53×29.5mm  
 拉力：280kg 或 350kg  
 电压：DC12V  
 工作电流：450mA  
 安全类型：通电上锁、断电开锁

Type: Single hanging type  
 Dimension: 208×53×29.5mm  
 Pull: 280kg or 350kg  
 Power supply: DC12V  
 Electrical current: 450mA  
 Safety mode: Power-on to lock, Power-off to open

## 附件类

### Accessories



4"×3"×3mm  
 4"×4"×3mm  
 4.5"×4.5"×3mm

型号：HwHinge 100  
 颜色：银色（钢拉丝）  
 材料：不锈钢

Model No.: HwHinge 100  
 Color: Satin Nickel  
 Material: Stainless Steel



4"×3"×3mm  
 4"×4"×3mm  
 4.5"×4.5"×3mm

型号：HwHinge 200  
 颜色：银色（钢拉丝）  
 材料：不锈钢

Model No.: HwHinge 200  
 Color: Satin Nickel  
 Material: Stainless Steel

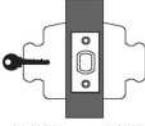
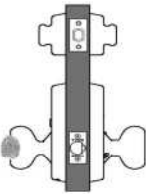
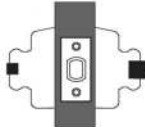
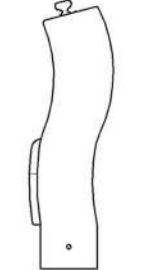
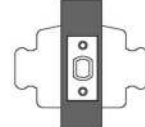
<p>指纹门锁 Fingerprint Entrance</p>	 <p>外锁体 内锁体 Outside Inside</p>	<ul style="list-style-type: none"> <li>• 适用于指纹和密码的大门</li> <li>• 具有单向弹簧锁头设计</li> <li>• 可替换球形或杆式或弧形杆式手柄</li> <li>• 自动上锁或免上锁的功能</li> <li>• 审计追踪</li> <li>• 拧内锁体手柄或扫描指纹或输入密码都可将锁打开</li> <li>• 内指旋器始终处于开启状态</li> <li>• For entrance doors fingerprint or passcode</li> <li>• Deadlocking latch bolt</li> <li>• Knob or lever or curve-in handles</li> <li>• Automatically or by-pass locking</li> <li>• Audit Trail</li> <li>• Turning inside knob or scan fingerprint or enter passcode will unlock latch</li> <li>• Inside knob always active</li> </ul>	<p>门锁 Entrance</p>	 <p>外锁体 内锁体 Outside Inside</p>	<ul style="list-style-type: none"> <li>• 适用于室内需要上锁的门</li> <li>• 具有无簧安全锁头和有单向弹簧锁头设计</li> <li>• 用钥匙和内指旋器均可锁上和开启内外指旋器</li> <li>• 可直接拧内指旋器</li> <li>• 内指旋器始终处于开启状态</li> <li>• For entrance doors</li> <li>• Deadbolt or deadlocking latch bolt</li> <li>• The key or thumb-turn locks and unlocks the lock</li> <li>• Turning the inside thumb-turn</li> <li>• Inside thumb-turn always active</li> </ul>
<p>指纹无簧安全门锁 Fingerprint Deadbolt Entrance</p>		<ul style="list-style-type: none"> <li>• 只相对于指纹和密码才能进入大门</li> <li>• 具有无簧安全锁头和有单向弹簧锁头设计</li> <li>• 可替换球形或杆式或弧形杆式手柄</li> <li>• 自动上锁或免上锁的功能</li> <li>• 审计追踪</li> <li>• 拧内锁体手柄或扫描指纹或输入密码都可将锁打开</li> <li>• 内指旋器始终处于开启状态</li> <li>• For entrance doors fingerprint or passcode</li> <li>• Deadbolt and deadlocking latch bolt</li> <li>• Knob or lever or curve-in handles</li> <li>• Automatically or by-pass locking</li> <li>• Audit Trail</li> <li>• Turning inside knob or scan fingerprint or enter passcode will unlock the deadbolt</li> <li>• Inside knob always active</li> </ul>	<p>浴室锁 Privacy</p>		<ul style="list-style-type: none"> <li>• 适用于浴厕或隔离用途的门</li> <li>• 具有无簧安全锁头和有单向弹簧锁头设计</li> <li>• 锁舌由内指旋器控制，外指旋器可由内指旋器的按钮锁死</li> <li>• 按内锁体按钮则为外锁体上锁</li> <li>• 拧内指旋器时，自动释放按钮</li> <li>• 在应急孔上插入无齿钥匙转动则可开门打开</li> <li>• 内指旋器始终处于开启状态</li> <li>• For lavatory or other privacy doors</li> <li>• Deadbolt or deadlocking latch bolt</li> <li>• Either thumb-turn operated latch bolt unless outside is locked by push-button inside</li> <li>• Pushing inside button locks the outside thumb-turn</li> <li>• Button automatically releases when inside knob is turned</li> <li>• A coin inserted and turned in emergency slot will unlock door from outside</li> <li>• Inside thumb-turn always active</li> </ul>
<p>指纹门控 Fingerprint Building</p>		<ul style="list-style-type: none"> <li>• 适用于指纹和密码的大门</li> <li>• 双门电磁锁</li> <li>• 从内门，具有 120 度人体微波感应开锁功能</li> <li>• 自动上锁或免上锁的功能</li> <li>• 审计追踪</li> <li>• 从室外由指纹或密码进入或从室内由人体微波感应开锁</li> <li>• 内指旋器始终处于开启状态</li> <li>• For entrance doors fingerprint or passcode</li> <li>• Electromagnetic locking</li> <li>• 120 degrees microwave motion sensor from inside the door</li> <li>• Automatically or by-pass locking</li> <li>• Audit Trail</li> <li>• Scan fingerprint or enter passcode or motion from inside will unlock the electromagnetic lock</li> <li>• Inside always active by motion</li> </ul>	<p>通道锁 Passage</p>		<ul style="list-style-type: none"> <li>• 适用于不需要上锁的门</li> <li>• 内外指旋器可随时启动锁舌。</li> <li>• 具有无簧安全锁头和有单向弹簧锁头设计</li> <li>• 适用于贮藏室，通道，厨房和儿童室</li> <li>• For doors that do not require locking</li> <li>• Either thumb-turn operates latch bolt at all time.</li> <li>• Deadbolt or deadlocking latch bolt</li> <li>• Suitable for use on storeroom, hall way, kitchen, and children's bedroom</li> </ul>

表面处理一览表  
Finish Breakdown

颜色代码 Finish Code	颜色说明 Finish Description
PB	Polish Brass 铜亮光(金色)
SN	Satin Nickel 钢拉丝(银色)
PN	Polish Nickel 珍珠铬
AB	Satin Antique Brass 青古铜

FengJian Industrial Area, Xingtan Town Shunde Foshan City,  
Guangdong Province, P.R.China. PC:528325

佛山市顺德区杏坛镇逢简工业区  
天驰电子有限公司

电话: +86-757-2289 8103

+86-757-2289 8104

传真: +86-757-2779 8111

<http://www.tychisystems.com>