

Installation Instructions

Flex - Series

Flex 100M and 200M Shown

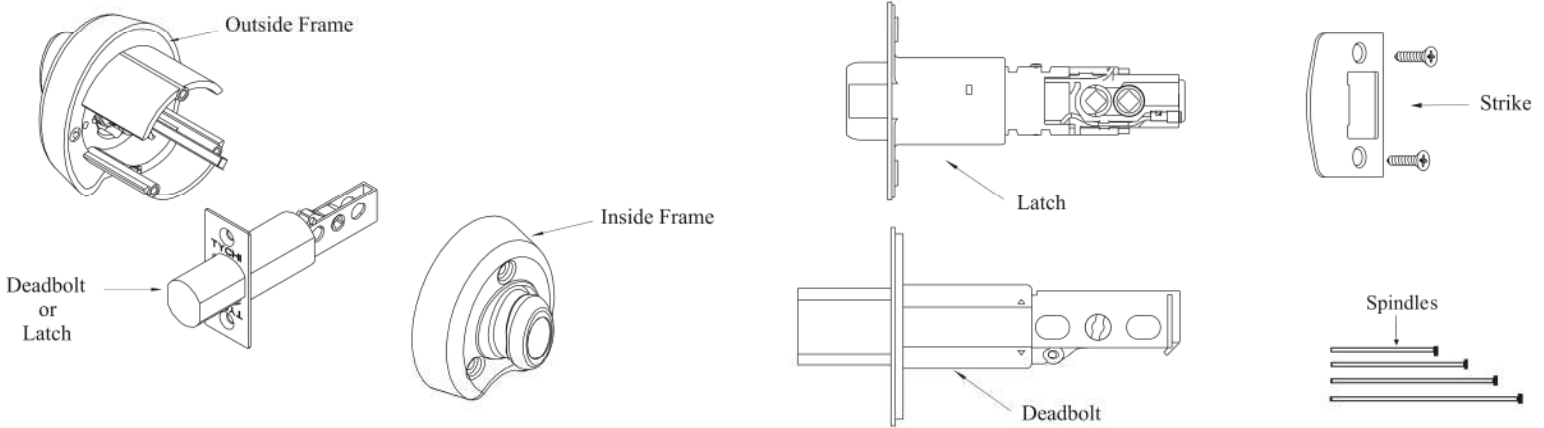

Door Preparation

- (1) (2) Before beginning to drill lockset holes, measure up 38" from lower edge of the door and mark heightline on edge of door in pencil. This will determine the height placement of the lock on the door.

Measure the thickness of the door. Mark the center point on the edge of door that intersects with the 38" heightline. This will determine where the latch hole must be drilled. The latch hole must be 1" in diameter.

Knob Hole – Drill a 2-1/8" hole into the face of the door. To prevent damaging to the wood door, bore from both sides. Make sure the finished hole is straight through and align with the body of the door.

Latch Hole – Drill a 1" hole into the edge of the door at the location where the center of the door thickness meet. If you are using a 2-3/8" backset, you should drill a hole 3-1/2" deep. If using a 2-3/4" backset, drill a 3-7/8" hole. The BioKnob latch works on either size backsets. We recommend using the 2-3/4" backset if you have a choice.

Latch Face Plate Chisel – Trace the outline of the face plate by inserting the latch into the edge of the door. Using a pencil to mark the screw hole centers and drill with a 1/8" drill. Chisel out the area for the face plate to a depth of 1/8" or until the face plate is level with the door edge.

- (3) Using the strike plate as the template for marking the chisel area. Located the center and mark strike mounting screws and centering points of the door thickness. Trace the outline onto the door frame using the mounting screw marks for location. At the screw marks, drill two 1/8" diameter pilot holes for #8 x 3/4" screws. At the center point bore a 1" diameter hole 1 1/4" deep.

Chisel the area marked for the strike to a depth of 1/16" until the strike plate is level with the door frame. Install the strike plate with the two #8 screws.

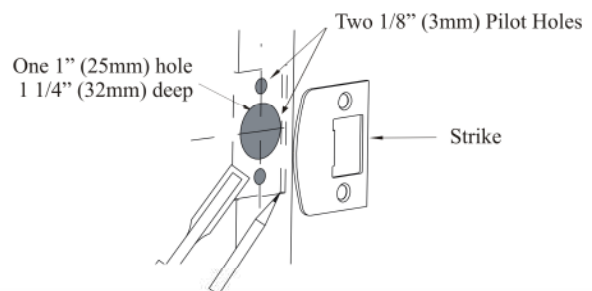
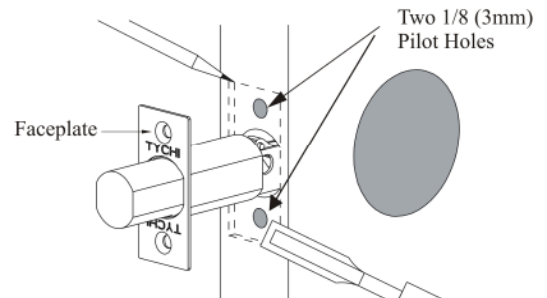
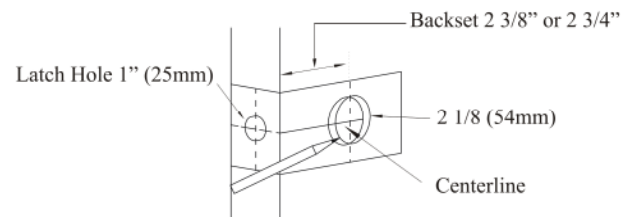
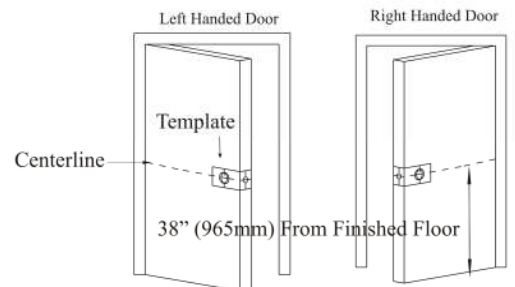

Lock Installation

Latch or Deadbolt Installation

Doors are usually pre-bored with 2-3/8" or 2-3/4" backset. The first hole from the latch-head is for 2-3/8" backset. The second hole is for 2-3/4" backset. There are no adjustments needed for the latch. If your holes are drilled correctly, the latch will automatically adjust to the size of the backset. For the deadbolt, there should be two sets come with the package. One for the 2-3/8" and one for the 2-3/4" backset

Slide the latch into the door with the tile angle side (Bevel) of the latch head facing the door jamb. Make sure the dead-pin is toward the inside of house. Secure with two #8 x 3/4" wood screws.

Secure the Deadbolt or Latch with two #8 screws

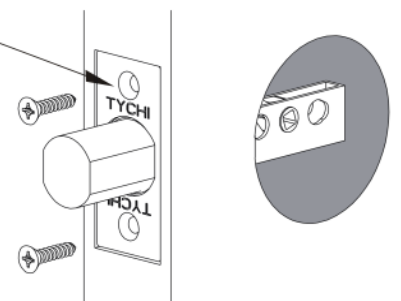

Outer Frame Installation

- a. Rotate thumbturn until spindle and thumbturn is aligned vertically.
- b. Insert spindle through hold in latch
- c. Slide outer frame toward door until flush

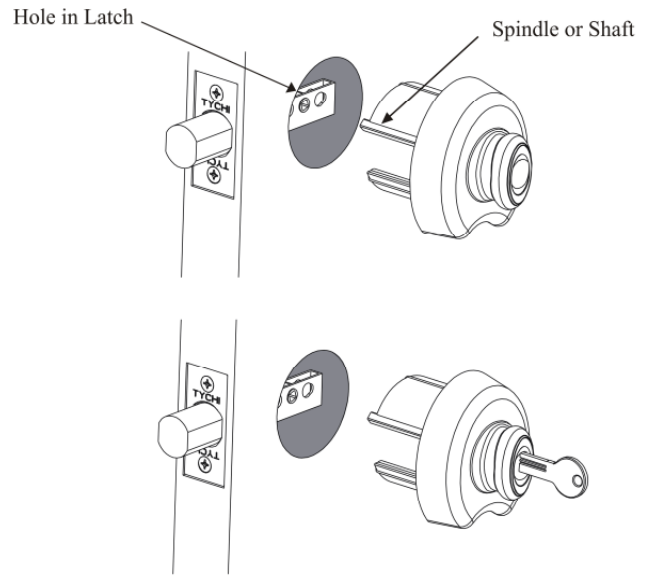

NOTE: For Flex 200M and Flex 300M, four Spindle come with each lock. They are use for toggling the locked and unlocked position of the lock. Each Spindle is for a specific thickness of the door. The shortest piece is for door thicknesses up to 1-3/8". The next size is for door thicknesses from 1-3/8" to 1-1/2". Then, 1-1/2" to 1-3/4" and finally the longest one is for 1-3/4" to 2".

By default Flex 200M and Flex 300M has a 1-3/8" Spindle already inserted into the outside lockset frame. For a thicker door, carefully remove Spindle and inserted the correct size into the shaft of the outside lockset.

Inside Frame Installation

- a. Rotate thumbturn until slot in inside frame is aligned with spindle and thumbturn is pointing vertically.
- b. Align holes in inside frame with shaft in the outside frame.
- c. Slide inside frame toward outer frame until flush.
- d. Insert three (3) screws into holes in inside frame and tighten.

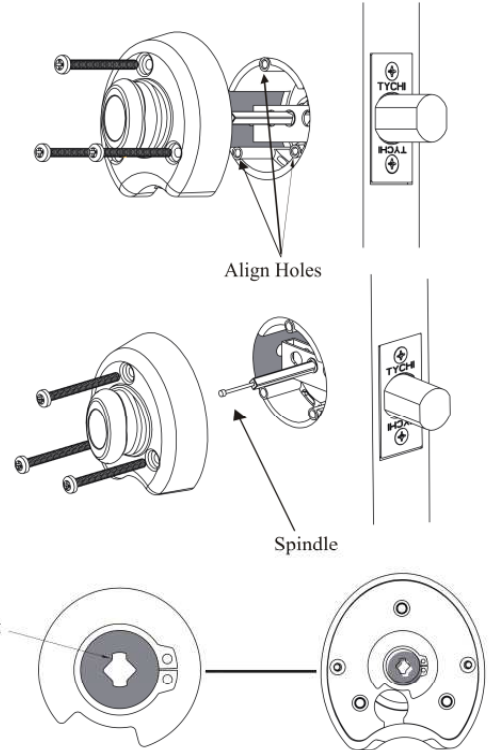

NOTE: For Flex 200M and Flex 300M, four Spindle come with each lock. They are use for toggling the locked and unlocked position of the lock. Each Spindle is for a specific thickness of the door. The shortest piece is for door thicknesses up to 1-3/8". The next size is for door thicknesses from 1-3/8" to 1-1/2". Then, 1-1/2" to 1-3/4" and finally the longest one is for 1-3/4" to 2".

By default Flex 200M and Flex 300M has a 1-3/8" Spindle already inserted into the outside lockset frame. For a thicker door, carefully remove Spindle and inserted the correct size into the shaft of the outside lockset.

Install Strike

Secure with two (2) strike screws.

Note: For Flex 200M and Flex 400M, ensure latch plunger hits strike

NOTE: Test the lock before closed door.

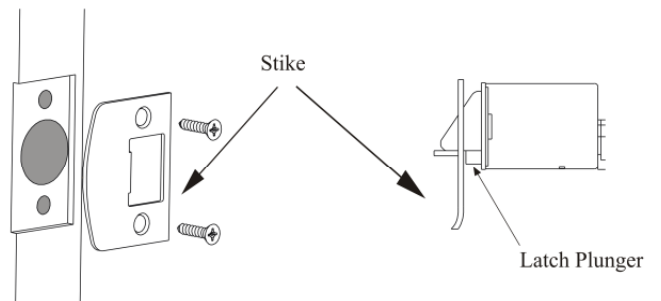

Flex Series

Flex 100M

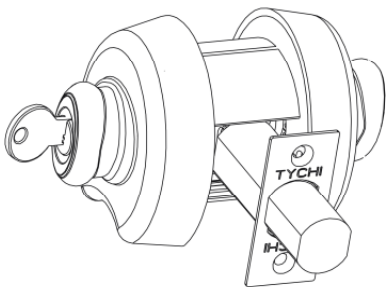

Flex 300M

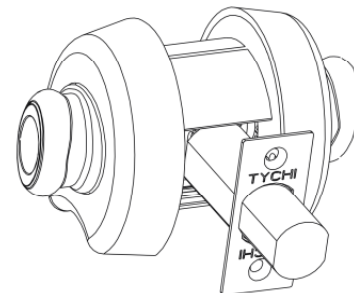

Flex 200M

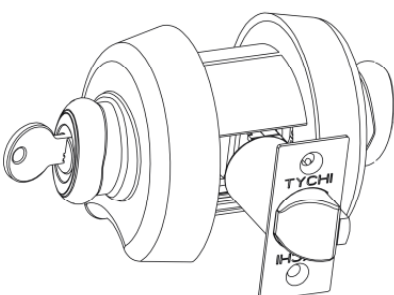

Flex 400M

